



QUICK START GUIDE FOR SX-3000 STANDALONE INTEGRATED MEDIA BLOCK™ WITH PSD-3000-P PORTABLE STORAGE DEVICE

English version

SMS version 9.0

July 24, 2013



STEP 1 Packing list

1. Remove the packaging from the box.
2. Check the contents of the box. The contents may vary by country/ region. Refer to the packaging for the actual contents.

SX-3000 Standalone Integrated Media Block™

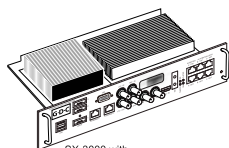

SX-3000 with
projector coverplate X 1*



RJ45 AES
audio cable X 2



RJ45 GPIO cable X 4
(optional)



Network
cable X 1



RJ45 to DB25
audio converter X 1

PSD-3000-P Portable Storage Device



PSD-3000-P Portable
Storage Device x 1



Bracket X 1*



2.5" SATA HDD X 3*



Power cord X 1



Power adapter X1



HDD tray key X 2



eSATA cable X 1

Technical Document



Manual CD X 1



Quick start guide X 1

* The type of coverplate depends on projector model.

* The type and number of bracket(s) may vary by shipment.

* The number of HDD is subject to change without notice due to ongoing product development and improvement.

STEP 2 Installing SX-3000

1. Remove existing interface board/ placeholders from projector.
(the location of board/ placeholders are different for each projector)
2. Install the SX-3000 into the projector. Please refer to Section 2 of SX-3000 with PSD-3000-P installation manual for installing SX-3000 into different projector models.

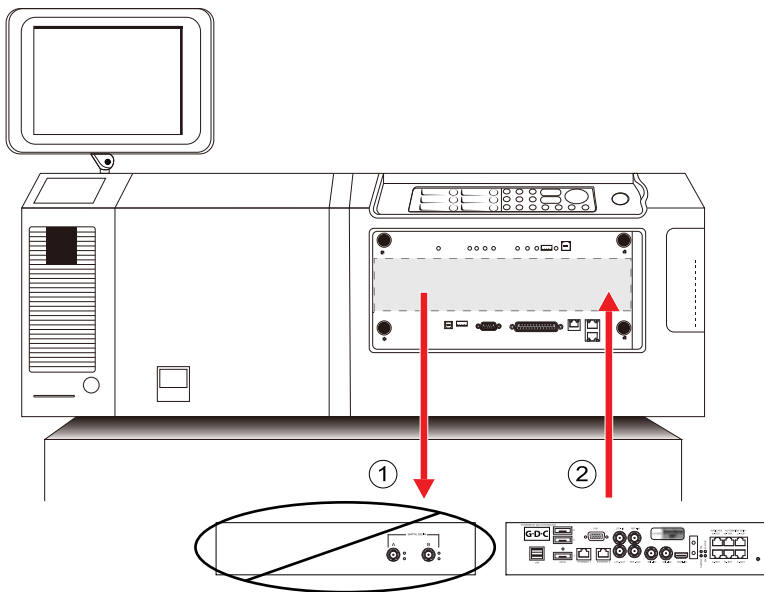

STEP 3 Projector network

1. Connect the provided Cat-5e LAN cable from the SX-3000 Ethernet 2 port to the projector's Ethernet port.
2. Connect an external monitor to the front VGA connection of the SX-3000.
3. Connect keyboard and mouse to the USB connection of the SX-3000.

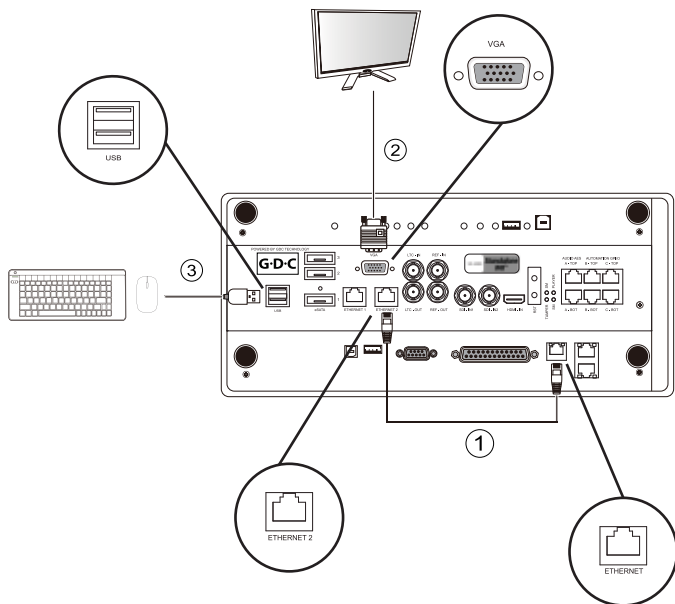

STEP 4 Installing PSD-3000-P external RAID unit

1. Ensure that the PSD-3000-P is powered off before installing the hard disk drives.
2. Push the lid to open the front door.
3. Release the HDD tray lock with provided key. (Rotate 90 degrees clockwise)
4. Open HDD tray cover door.
5. Insert the provided 2.5" HDDs into the tray and close the cover door.
6. Lock the HDD tray by using the key. (Rotate 90 degrees counterclockwise)

Caution:

1. Please gently push the door when closing to avoid damage to the component.
2. If a HDD is inserted incorrectly, do not force the HDD tray door closed. This will damage the PSD-3000-P.

②

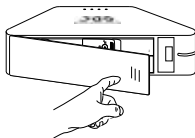

④

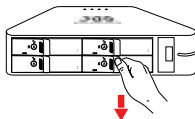

③

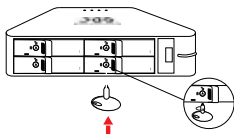

⑤

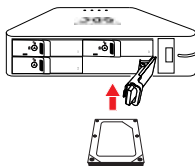

STEP 5 Installing PSD-3000-P onto the projector

1. Loosen the screws on the projector.
2. Remove the metal rings* from the screws and take out the screws from the hole in order to open the bracket on the side cover.
3. Place in the screws back into the side cover and insert the new metal rings* on the screws.
4. Install the bracket back onto the projector and tighten the screws. (the location of the bracket is different depending on the projector model)
5. Mount PSD-3000-P onto the bracket.

* Metal rings will come with the Barco projector only

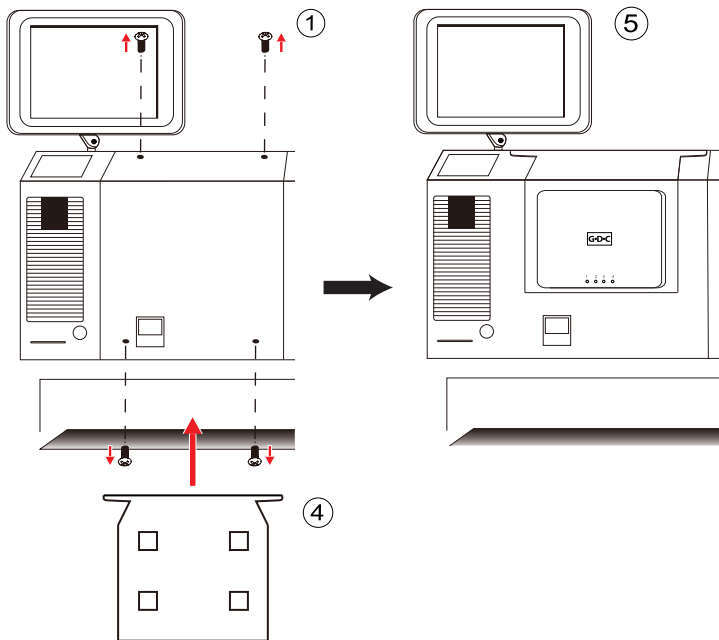

STEP 6 Connecting PSD-3000-P drive bay to SX-3000

1. Connect the eSATA port on the back of the PSD-3000-P to the eSATA port 1 on the SX-3000.
2. Connect the provided 5V power supply to a power source and to the back of the PSD-3000-P.
3. Power on the PSD-3000-P with the switch next to the power plug. Then power on the projector with SX-3000 before moving on to Step 7.

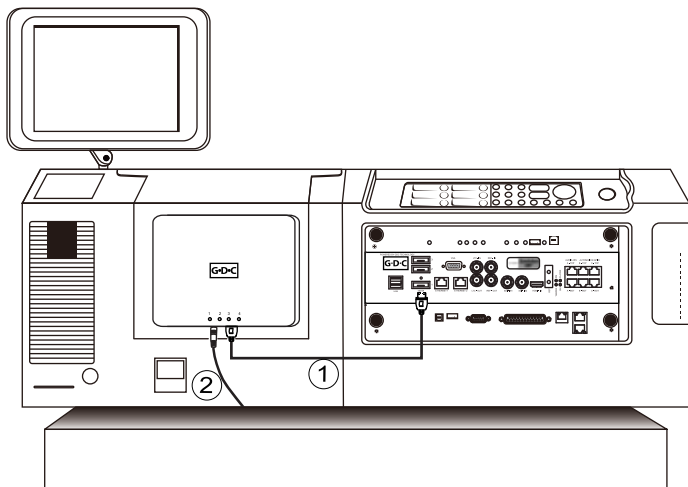

STEP 7 Operating the SX-3000 with the PSD-3000-P



You can now start to use the SX-3000 and PSD-3000-P by accessing the SMS interface. For details, please refer to SX-3000 with PSD-3000-P user manual.

Should you have any questions, please contact 24/7 engineering support hotline:

North America	+1 877 743 2872 (Toll Free)	Latin America	+52 55 8851 1198
Europe	+34 928 22 80 20	China	+86 400 886 0996 (Toll Free)
North Asia	+852 3520 0920 (Toll Free)	South East Asia	+65 6100 4328
Australia/ New Zealand	+61 407 040 744		

Copyright © 2013 GDC Technology Limited, All rights reserved, All trademarks listed in this manual are properties of their respective owners. Specifications are subject to change without notice due to ongoing product development and improvement.